

*Lens for S-Mount Board Cameras*

Model	VS-B0624H
Focal Length (f)	6 mm (6.02)
Maximum Aperture Ratio	1: 2.4
Aperture	F2.4
Angle of View (1/2")	44.8° × 58.7° (Diagonal: 71.6° )
M.O.D	100 mm
TV Distortion (1/2")	-2.71 %
Wavelength	Visible
Mount	M12 P=0.5
MechanicalBack	6.02 mm
Sensor Size (max.)	1/2"
Filter Thread	-
Weight (approx.)	8 g
Dimension	$\phi$ 17 (max.) × L = 20.5 mm

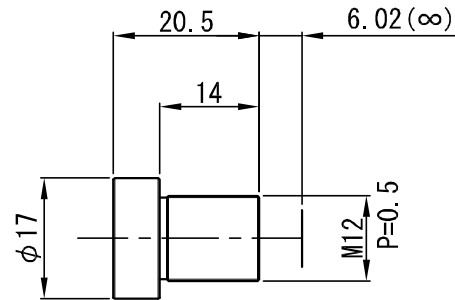

$\triangle \times$				APPROVED	CHECKED	MATERIAL 材料	-	CHAMFER 一般面取	-	QUANTITY 个数				
$\triangle \times$				T. A.	T. A.	TREATMENT 处理	-	FINISHING 仕上	-	-				
$\triangle \times$						TREATMENT CONTACT 处理接点	-	DECENTRATION 偏芯	-					
$\triangle \times$				DESIGNED	DRAWN	OVER 250 UP TO 1000	$\pm 0.3$	$\pm 0.5$	$\pm 1.0$	$\pm 0.2$	UNIT (mm)	ANGLE 角度	METHOD 图法	REMARK 適用 (機種名)
$\triangle \times$				T. A.	S. K.	OVER 63 UP TO 250	$\pm 0.2$	$\pm 0.3$	$\pm 0.6$	$\pm 0.15$		-		VS - B 0 6 2 4 H
$\triangle \times$								OVER 16 UP TO 63	$\pm 0.1$	$\pm 0.2$	$\pm 0.4$	$\pm 0.1$	SCALE	1 / 1
NO. x 箇所	REVISION 訂正事項	DATE	NAME			OVER 0 UP TO 16	$\pm 0.05$	$\pm 0.1$	$\pm 0.2$	$\pm 0.1$	DATE	15.01.05	DRAW NO.	0 D S V 0 1 4 2 A 1
						TOLERANCES	A	B	C	S				