

Model	SV-5018V
Focal Length	50 mm (47.97)
Maximum Aperture Ratio	1:1.8 (1.87)
F.No	F1.8 ~ Close
Angle of view (2/3")	7.9° × 10.5° (Diagonal: 13.1°)
M.O.D	1000 mm ~ ∞
Flange back	17.526 mm
Operation of Iris & Focus	Manual
Mount	C-mount
Filter Thread	M30.5 mm P= 0.5
TV distortion (2/3")	0.12 %
Sensor size (max.)	2/3"
Weight (approx.)	67 g
Dimension	φ 32 (MAX) × L= 37 mm

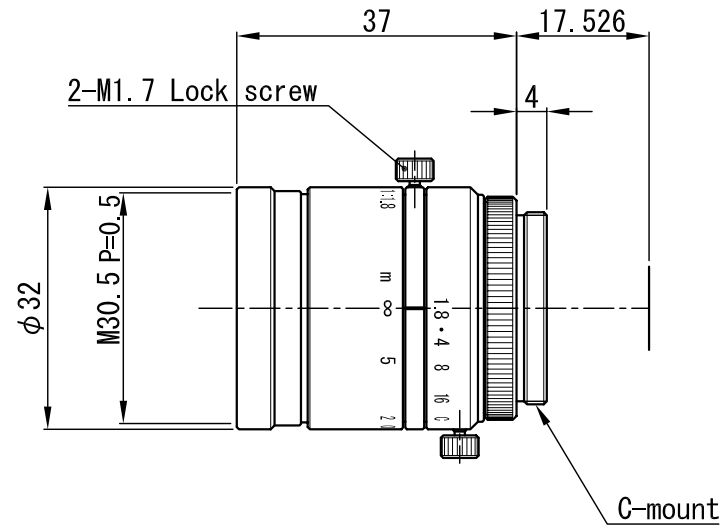

△				APPROVED	CHECKED	MATERIAL 材料	-	CHAMFER 一般面取	-	QUANTITY 個数				
△				T. A.	T. A.	TREATMENT 処理	-	FINISHING 仕上	-	-				
△						TREATMENT CONTACT 処理接点	-	DECENTRATION 偏芯	-					
△				DESIGNED	DRAWN	OVER 250 UP TO 1000	±0.3	±0.5	±1.0	±0.2	UNIT (mm)	ANGLE 角度	METHOD 図法	REMARK 適用 (機種名)
△						OVER 63 UP TO 250	±0.2	±0.3	±0.6	±0.15		-		SV-5018V
△						OVER 16 UP TO 63	±0.1	±0.2	±0.4	±0.1	SCALE	1 / 1	NAME	外觀圖
△						OVER 0 UP TO 16	±0.05	±0.1	±0.2	±0.1				
	DATE	EXCH NO.	REVISION 変更記事	T. A.	T. T.	TOLERANCES	Ⓐ	B	C	S				