

Line Scan Macro Lens

Model	VS-L6035/V
Focal Length (f)	60 mm (60.03)
Optical Mag.	× 0.165
WD	349.2 mm ± 11
O/I (Object & Imager Distance)	530.2 mm
Aperture	F 3.5 ~ 22
Working F/# *Value at Iris Open	4.1
NA	0.020
DOF at PCoC ϕ 0.04mm	12.0 mm
Optical Distortion (Y=31)	-0.08 %
Operation	Manual (Lock Screw M2)
Wavelength	Visible
Mount	V-Mount
Flange Back	87.0 mm
Image Circle	ϕ 62 mm
Filter Thread	M 67 P= 0.75
Weight (approx.)	360 g
Dimension	ϕ 70 (max.) × L = 94 mm

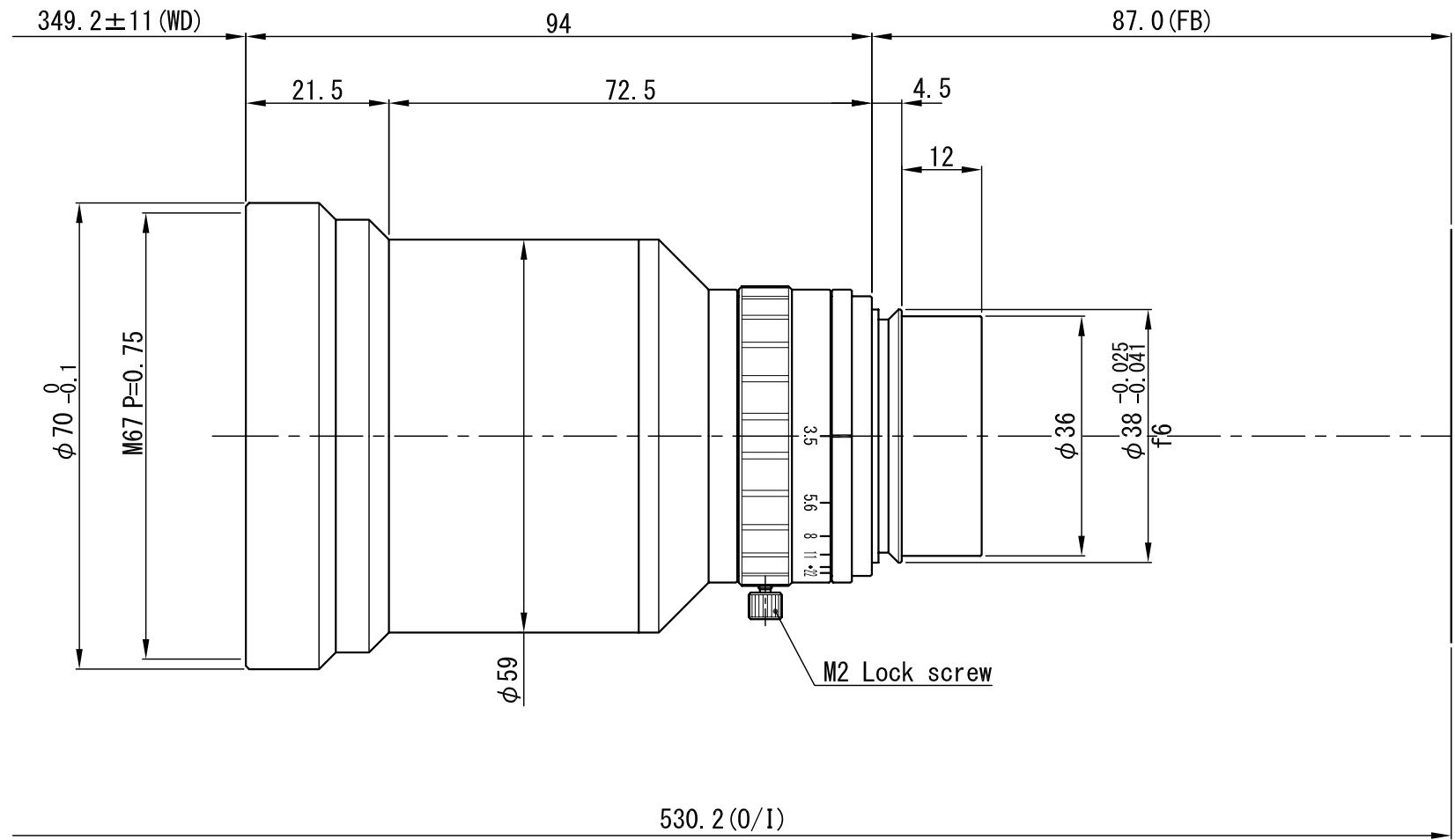

△				APPROVED	CHECKED	MATERIAL 材料	-	CHAMFER 一般面取	-	QUANTITY 個数	
△				T. A.	T. A.	TREATMENT 処理	-	FINISHING 仕上	-	-	
△						TREATMENT CONTACT 処理接点	-	DECENTRATION 偏芯	-		
△				DESIGNED	DRAWN	OVER 250 UP TO 1000	±0.3 ±0.5 ±1.0 ±0.2	ANGLE 角度	METHOD 図法	REMARK 適用 (機種名)	
△				T. A.	T. T.	OVER 63 UP TO 250	±0.2 ±0.3 ±0.6 ±0.15	UNIT (mm)		VS-L6035/V	
△						OVER 16 UP TO 63	±0.1 ±0.2 ±0.4 ±0.1	SCALE			1 / 1
	DATE	EXCH NO.	REVISION 変更記事			TOLERANCES	Ⓐ B C S	DATE	11.05.18	DRAW NO.	01D MC 0250A1